

MURRAY COUNTY.

Section 15
 10798 McGill-Warner Co., Blank Book Manufacturers, St. Paul.

Township 105

Range 41

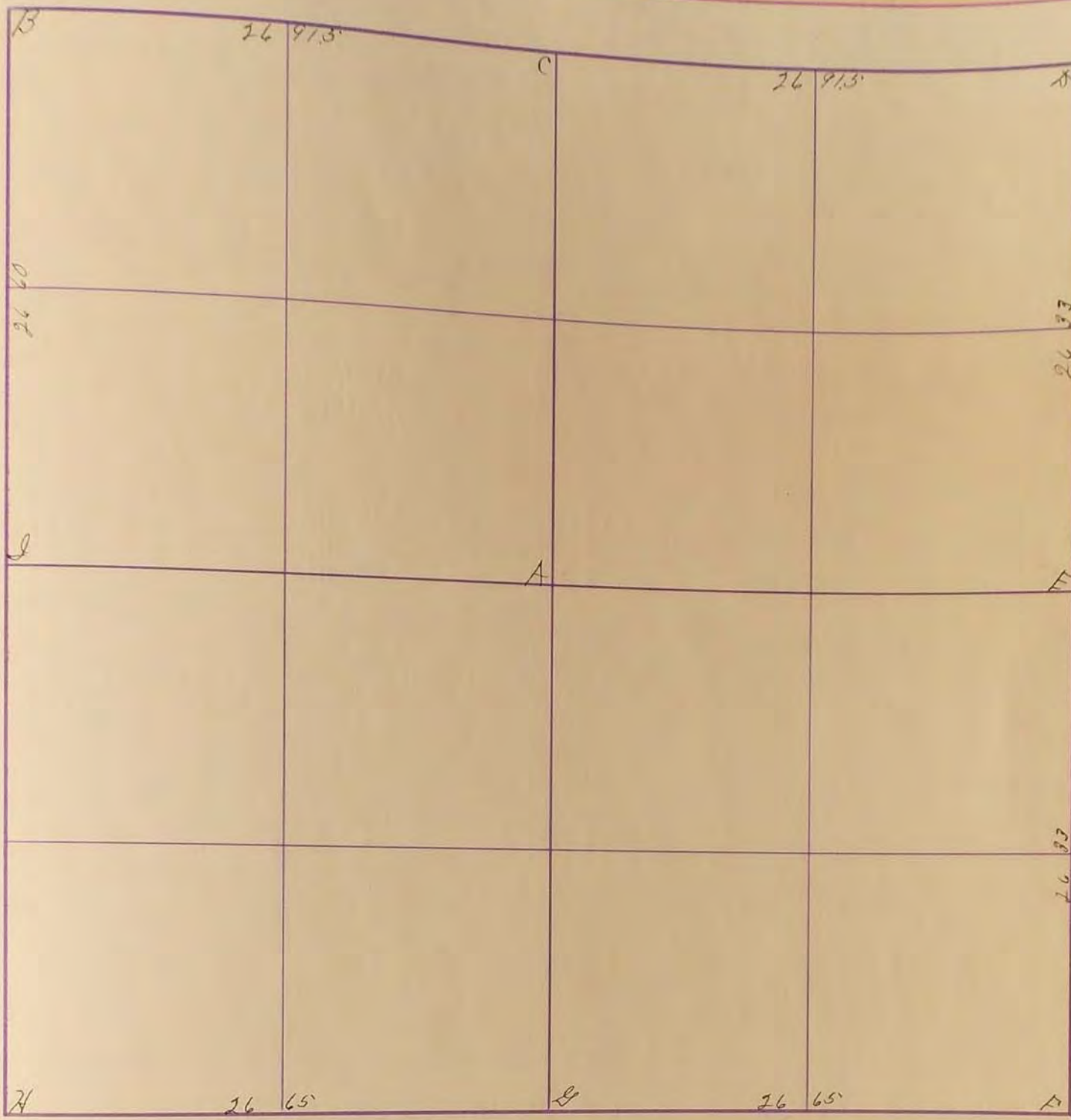

Dec 2-1901

- A.
- B. Stone in mound sec 16 in cor. of hills sec 15
- C.
- D. Gov. mound & stone
- E. Stone 10x12x18 (grey)
- F. Stone in grade
- G. " " "
- H. Gov. State mound & stones
- I. " " " in "

J.W. Thostelmaroff

June 7, 1932

- D. Established from D-E. Sec 10
- E. Found old corner placed stone 8x12x20 grey 8' front of line D.F.
- F. Found old corner stone

Feb. 6, 1934

- D. concrete stone with X R.P. tack in blazed box elder N.E. ^{74.2} 76.2'
- D. R.P. tack in cor fence post N.W. 113.2' west end of culvert 30.3'
- E. concrete stone with X R.P. tack in Blazed Fence Post N.W. 112.5'
- E. R.P. tack in cor. fence post west on line 33-4'
- F. concrete R.P. tack in tel pole N.E. 46.4'
- F. R.P. tack in cor fence post S.W. 45.3' R.P. tack in tel pole N.E. 45.2'
- F. R.P. tack in cor fence post S.W. 45.3' R.P. tack in tel pole N.E. 45.2'

F.A. March

"1936"

- "B" TACK IN CORNER FENCE POST N.W. 97.2
- "Rock" TACK IN COR. FENCE POST S.W. 95.5
- TACK IN COR. FENCE POST S.E. 35.1
- TACK IN COR. FENCE POST N.E. 38.2
- "H" TACK IN FENCE POST COR. N.E. 41.2
- "H" TACK IN TEL. POLE S.E. 51.2
- "C" TACK IN BLAZED S. ASH S.W. 39.8
- "I" TACK IN FENCE POST S.E. 37.8 FENCE
- ← cor. 9' west of stone (1010 1956)
- "I" TACK IN COR. POST N.E. 35.6'
- "I" TACK IN BLAZED FENCE POST 70.6
- STONE 15' S. OF E. + W FENCE.
- "A" CONCRETE STONE WITH TACK ON TOP
- "C" 2x2" 400" R.P. Bottle cap in fence post
- 35.49.2; R.P. Bottle cap in right of way post
- 31.69.5'
- "D" "Conc. Stone" R.P. Bottle cap Box Elder
- Tree N.E. 102.4'; R.P. Edge of steel cor.
- post N.W. 68.2'. (1956)

14
 15
 16
 17
 18
 19
 20
 21
 22
 23
 24
 25
 26
 27
 28
 29
 30
 31
 32
 33
 34
 35

SURVEY No. _____

Section 15

Town 105

Range 41

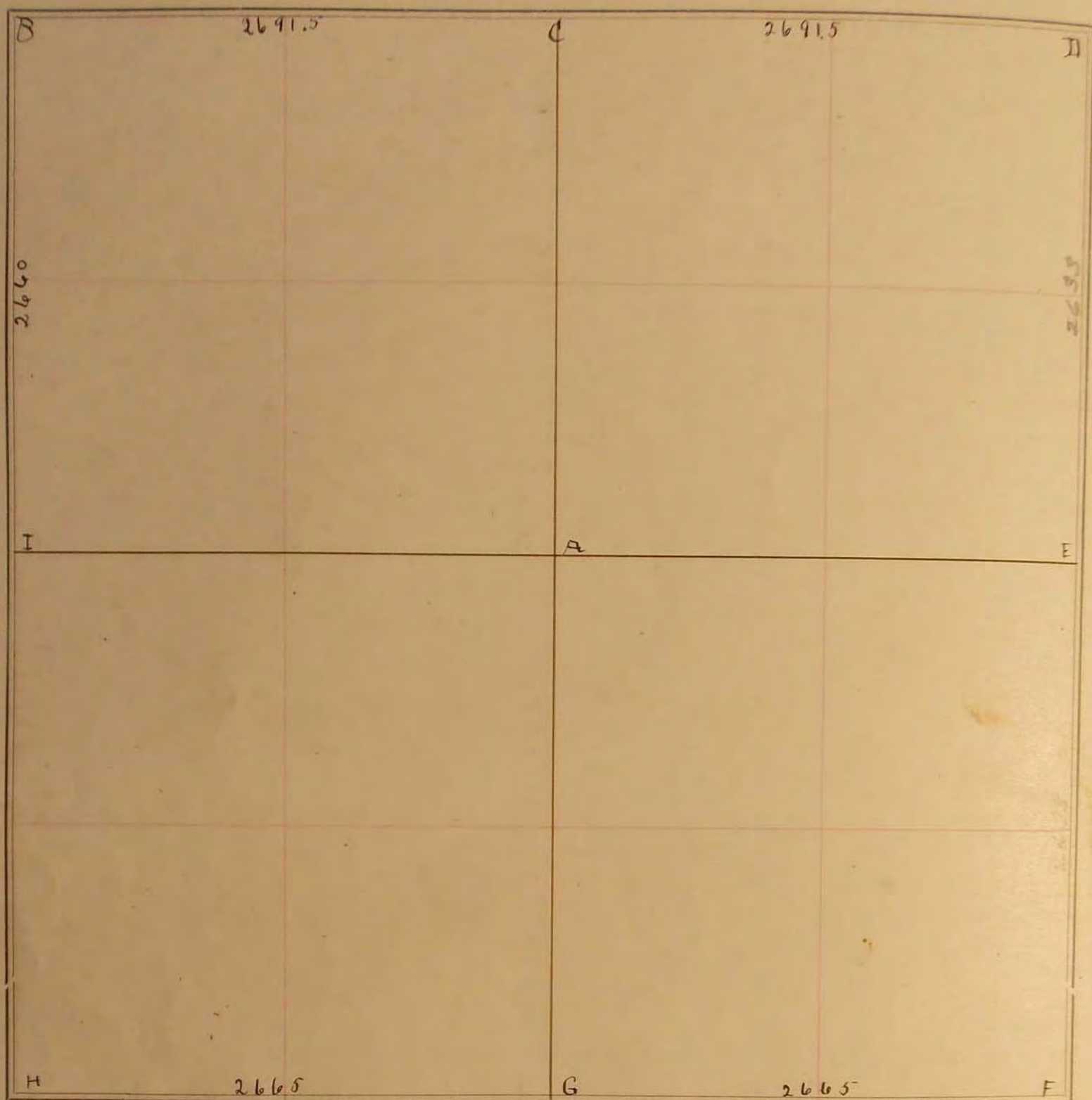

FIELD NOTES.

Dec. 2, 1901

- A
B Stone in mound, in cor of fields (Sec 15)
C
H Gov. mound + stone
E Stone 10x12x15 (grey)
F " in grade
G " " "
H Gov stake, mound + stone
I " " in "

J. W. Woodstetter

June 7, 1932

- H. Established from D-E to 10
E. Found old corner found stone 8x12x20 gray - 8' East of line H-F.
F. Found old corner stone.

Feb 5, 1934

- "D" Concrete Stone with X R.P. Tack in Blazed Box Elder NE 76.5'
"D" R.P. Tack in cor fence post N.W. 45.5' west End of Culvert 30.7'
"E" Concrete Stone with X R.P. Tack in Blazed fence post N.W. 42.4'
"E" R.P. Tack in cor fence post west on Line 33.5'
"F" Concrete Stone R.P. Tack in tel pole NE 46.5'
"F" R.P. Tack in cor fence post S.W. 43.5' R.P. Tack in tel pole S.E. 45.7'

J. A. March.